

With Us, You can



# HIGH GREEN SAFE

	32 m
	16,4 m
	250 kg
	Bi-energy Eco Hybrid
	Crawlers





## SPIDER LIFT



### STANDARD EQUIPMENT

- Available power options: Bi-energy (Diesel + AC), Eco (AC+Battery), Hybrid (Diesel + AC + Battery)
- Emergency electropump
- Pistons hydraulic pump at variable displacement for fast and sharp movements and consumption savings. CAN-BUS distributor + CANBUS electronics
- "Return to home" function
- Hydraulic steering and transmission on rubber tracks whit hydraulically variable external width
- Independent outriggers rotating on 2 different positions
- Automatic set-up with self-levelling
- Turntable rotation at 660°
- Double steel made pantograph, telescopic boom + fixed jib
- Hydraulic and electric lines inside the boom
- Removable aluminium alloy aerial cage 180x70x110 cm, with hydraulic rotation 90° + 90°
- "Area manager" limiting device for safe working load 120 and 250 kg
- Radio control at the ground + electric control at the cage
- 230VAC electric plug on the cage
- PalSystem with touchscreen monitor for diagnostics and monitoring of operating parameters
- CE Mark homologation certificates, manuals, stickers and spares book in English language

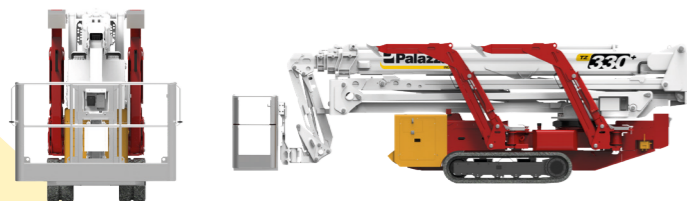

## OPTIONAL

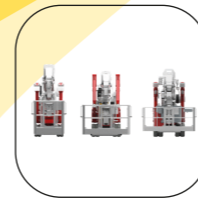

**CAGES OF DIFFERENT SIZES**  
Different sizes aluminium cages for one man, or majored to accommodate more people or bulky equipment.



**CIRCUITO INTERFONICO**  
Di comunicazione a viva voce, fra la navicella aerea e la torretta al suolo.



**CASTORS UNDER THE CAGE**  
4 wheels mounted under the basket for easily moving it when dismounted.

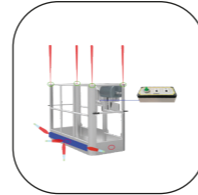

**BASKET ANTI-COLLISION KIT**  
The laser sensors are positioned at the four corners of the basket and monitor the distance between the operator and any vertical obstacles. Ultrasonic sensors check the presence of any obstacles around the perimeter.



**NON-MARKING TRACKS**  
white rubber, ideal to operate indoor and/ or on delicate floors



**PEDAL TO THE CAGE**  
Safety pedal to operate the movements from the cage.



**TOUCHSCREEN MONITOR IN THE CAGE**  
Installed on the cage control panel, providing the operator with all detailed and salient information of the aerial working platform he needs during aerial work.



**ANEMOMETER**  
device for measuring the wind, with an acoustic warning of the wind max speed allowed for aerial working

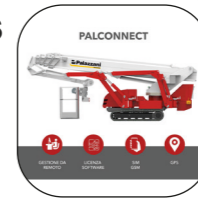

**KIT PALCONNECT**  
Remote connection service with the aerial platform that allows the user to monitor the key parameters of use of the machine and intervene with some of them.



**PROTECTION OF PRUNERS**  
Covers kit in iron for delicate parts of the machine such as cylinders stems, valves and reels to protect against branches or other materials falling from above.



**CUSTOMIZED COLOURS**  
Possibility to customize the colours of the tracked lift with different RAL according to the client's corporate livery

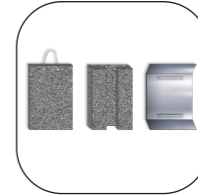

**PADS FOR OUTRIGGERS**  
Different type of pads to distribute the load of the stabilizers on the ground and have greater stability of the machine.



**ADDITIONAL AIR/WATER PIPES**  
Extra-large diameter compressed air/water pipe to the basket.



**ELECTRIC GENERATOR**  
230VCA single-phase, powered by the diesel engine, connected to an electrical socket in the cage, for the use of electrical tools during aerial working



**LED LIGHT**  
One or more additional led headlights installed on the basket or on the boom.



**BI-ENERGY**



Diesel  
18,2 kW



Single-phase  
Electric motor  
230VAC - 3 kW

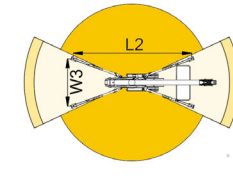
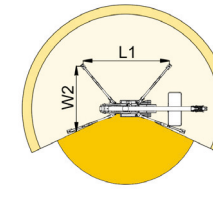
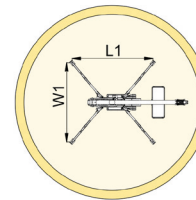
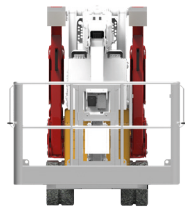
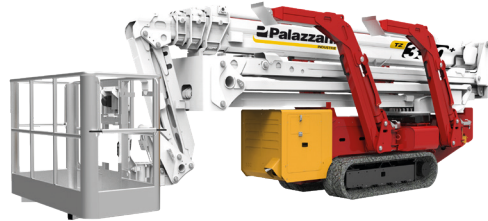
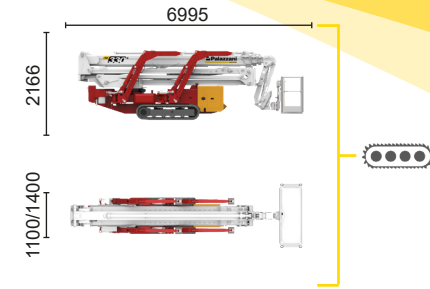
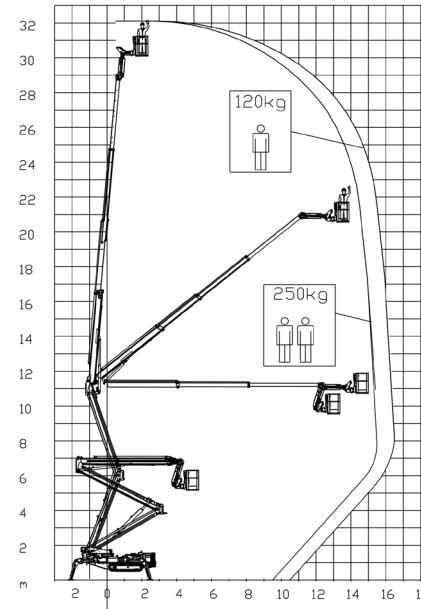

15,4 m	16,4 m	9,5 m	L1	L2	W1	W2	W3
250 kg	120 kg	250/120 kg	4725 mm	6170 mm	4910 mm	4020 mm	3130 mm



TZ 330+/C  32 m 16,4 m 250 kg 360° 180x70 cm 90°+90° 3,13-4,9 m 18% 32% 2,4 km/h 7200 kg 49 kN 3,1 kN/m<sup>2</sup> 5,72 kN/m<sup>2</sup>

Available power options:

**BI-ENERGY** (DIESEL+AC)

**ECO** (AC+BATTERY)

**HYBRID<sup>2</sup>** (DIESEL+AC+BATTERY)

Characteristics and technical data are informative only and subjected to change without notice.

Palazzani Industrie S.p.A.

Via del Pavione, 4 - 25050 - Paderno F.C. (BS) - Italy

Tel. (+39) 0306857073

info@palazzani.it

www.palazzani.it



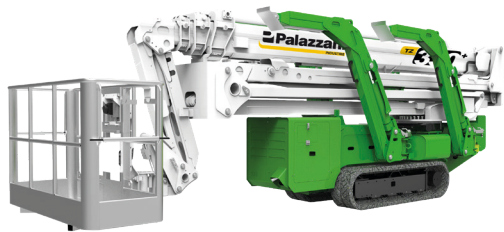

**ECO**

---

Single-phase  
Electric motor  
230VAC - 16 kW

---

Lithium iron  
phosphate battery  
LiFePO4  
48V - 315 Ah

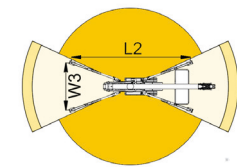
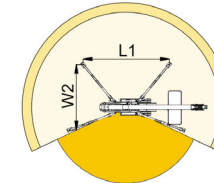
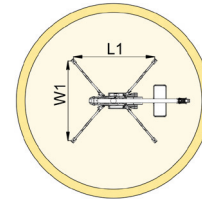
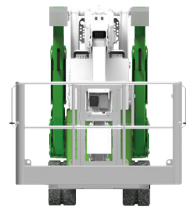
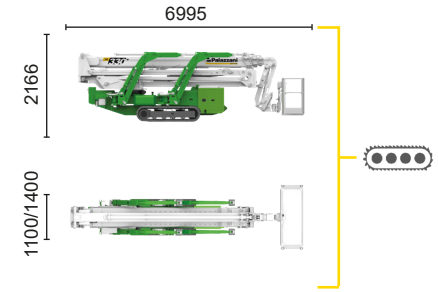
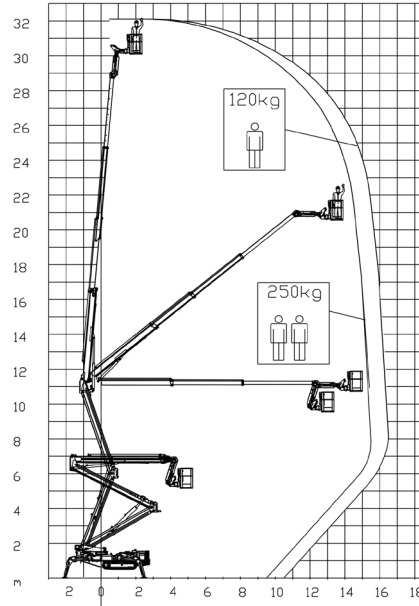

15,4 m	16,4 m	9,5 m	L1	L2	W1	W2	W3
250 kg	120 kg	250/120 kg	4725 mm	6170 mm	4910 mm	4020 mm	3130 mm



TZ 330+/C		32 m	16,4 m	250 kg	360°	180x70 cm	90°+90°	3,13-4,91 m	18%	32%	2,4 km/h	7200 kg	49 kN	3,1 kN/m <sup>2</sup>	5,72 kN/m <sup>2</sup>
-----------	--	------	--------	--------	------	-----------	---------	-------------	-----	-----	----------	---------	-------	-----------------------	------------------------

Available power options:

**BI-ENERGY** (DIESEL+AC)

**ECO** (AC+BATTERY)

**HYBRID<sup>2</sup>** (DIESEL+AC+BATTERY)

Characteristics and technical data are informative only and subjected to change without notice.

Palazzani Industrie S.p.A.

Via del Pavione, 4 - 25050 - Paderno F.C. (BS) - Italy

Tel. (+39) 0306857073

info@palazzani.it

www.palazzani.it





NC 852 A 22



**HYBRID<sup>2</sup>**

 Diesel  
14,7 kW

 Single-phase  
Electric motor  
230VAC - 16 kW

 Lithium iron  
phosphate battery  
LiFePO4  
48V - 315 Ah

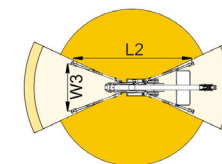
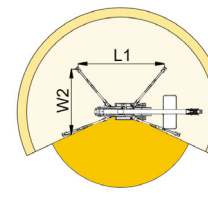
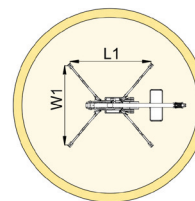
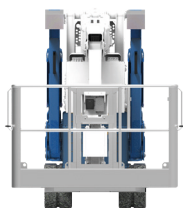
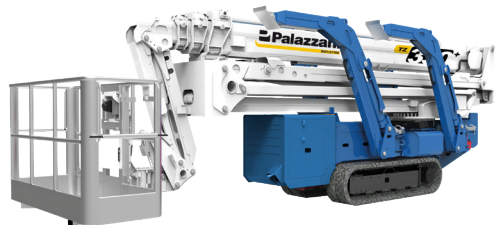
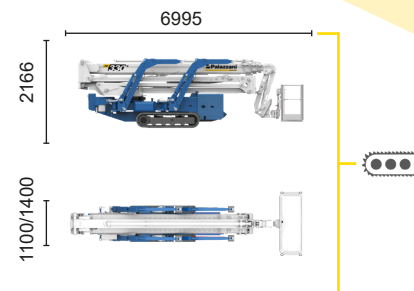
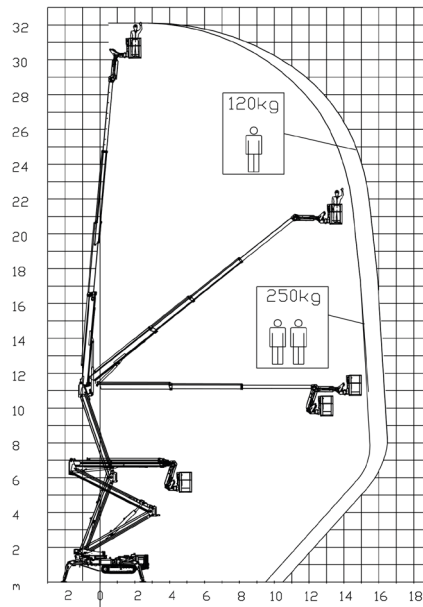

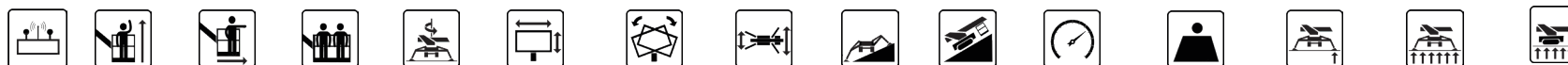

15,4 m	16,4 m	9,5 m	L1	L2	W1	W2	W3
250 kg	120 kg	250/120 kg	4725 mm	6170 mm	4910 mm	4020 mm	3130 mm



TZ 330+/C  32 m 16,4 m 250 kg 360° 180x70 cm 90°+90° 3,13-4,91 m 18% 32% 1,8 km/h 7640 kg 49 kN 3,22 kN/m<sup>2</sup> 5,92 kN/m<sup>2</sup>

Available power options:

-  **BI-ENERGY** (DIESEL+AC)
-  **ECO** (AC+BATTERY)
-  **HYBRID<sup>2</sup>** (DIESEL+AC+BATTERY)

Characteristics and technical data are informative only and subjected to change without notice.

Palazzani Industrie S.p.A.  
Via del Pavione, 4 - 25050 - Paderno F.C. (BS) - Italy  
Tel. (+39) 0306857073  
info@palazzani.it  
www.palazzani.it

